



MEDLINE **TEXTILES**
For Healthcare Professionals



Shouldn't a patient gown be more than just something to wear?

INTRODUCING THE
Disney
COLLECTION



When Medline looks at pediatric patient apparel, we certainly expect more. Comfort. Safety.* Modesty. Satisfaction—for both patients and parents. And quite possibly, even better outcomes.

Many adults say that the traditional gown is one of their biggest gripes about a hospital stay. Medline’s research with a young patient group at a renowned children’s hospital confirmed that kids feel the same way.

That’s why Medline pediatric apparel is designed to promote the young patient’s comfort and well-being while still making it easy for the caregiver to deliver essential care.

After all, whether in a hospital or at home, a kid should still get to be a kid.



Contents

| | |
|--|-------|
| Disney® Mickey Mouse® Gowns | 4-5 |
| Disney® Minnie Mouse® Gowns | 6-7 |
| Pet Parade Gowns  | 8-9 |
| Tired Tiger Gowns | 10-11 |
| Snuggly Solids Gowns | 12-13 |
| Infant Headwarmers & Booties | 14-15 |
| Infant Shirts & Gowns | 16-17 |
| Kuddle-Up Baby Blankets | 18-21 |
| Sheets, Burp Cloths & Cloth Diapers | 22-23 |
| Scales & Exam Papers | 24-25 |
| Thermometers | 26 |
| Stethoscopes & Aneroids | 27 |
| Electrodes & Cuffs | 28 |
| Nebulizer, Oximeters & ID Bracelets | 29 |
| Diapers & Wipes | 30 |
| Admission Kits | 31 |
| Mobility | 32-33 |
| Bandages | 34 |
| The Classics & The Latest | 35 |



Green

Everyone's favorite pal...

With Mickey for boys and Minnie for girls, these gowns are sure to bring a smile. A comfort-cut design makes them a pleasure to wear. Colorful, soft napped knit fabric feels gentle and smooth against the skin, and it's tested to keep looking—and feeling—good after laundering.

Several other features help make this your favorite gown. The gown is extra long, so the smaller size fits 2-4 year-olds and the larger fits kids 5-10. Both feature pediatric-sized plastic snaps (not metal), so they're safe for MRIs. The fabric is also completely opaque, supporting the child's modesty. Like every piece of Medline pediatric apparel, the Disney line meets all U.S. flame retardency specifications.



The classic Disney logo, featuring the word "Disney" in its signature script font.



Light Blue



Light Blue



Green

| Item No. | Size | Color | Pkg |
|--|---------|------------|---------|
| Mickey Mouse IV Gowns - Plastic Snaps | | | |
| MDT011586B | Toddler | Light Blue | 2 dz/cs |
| MDT011587B | Kid | Green | 2 dz/cs |

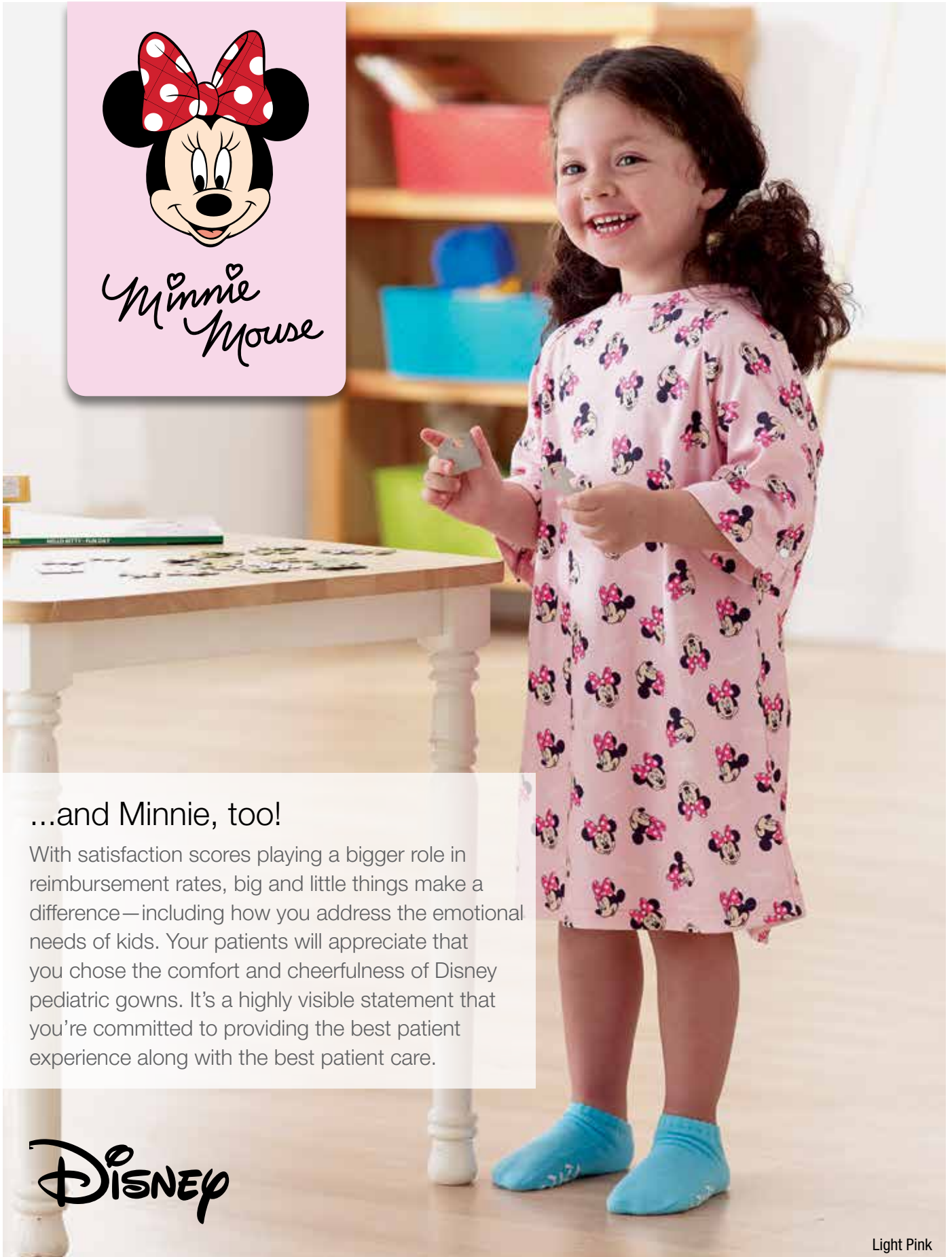

...and Minnie, too!

With satisfaction scores playing a bigger role in reimbursement rates, big and little things make a difference—including how you address the emotional needs of kids. Your patients will appreciate that you chose the comfort and cheerfulness of Disney pediatric gowns. It's a highly visible statement that you're committed to providing the best patient experience along with the best patient care.

The classic Disney logo, featuring the word "Disney" in its signature script font.

Light Pink



Pink



Pink



Light Pink

| Item No. | Size | Color | Pkg |
|--|---------|------------|---------|
| Minnie Mouse IV Gowns - Plastic Snaps | | | |
| MDT011586G | Toddler | Light Pink | 2 dz/cs |
| MDT011587G | Kid | Pink | 2 dz/cs |

Pet Parade



Everyone loves a parade
— especially a parade of
dogs and cats!

Pet Parade features an oh-so-comfy jersey knit fabric—just like your favorite t-shirt. It's everything a great IV gown and pant should be: stretchy and soft. On top of it all, Pet Parade features a flurry of fun with furry friends all over the gown. How many different ones can you count?

Teal - Medium



The gown is designed with a long length to promote patient dignity and enhance sizing flexibility. Solid color matching pants mean an even greater set of wear options. Extensive testing in the harshest laundering conditions has proven Pet Parade's durability. The IV sleeve snaps are sturdy and non-metallic. For convenience, each size has its own color.

Length was a key consideration in the design of the pants in the Pet Parade line. They start with a covered elastic waistband that stays up better than drawstring-waisted pants. Along with a slightly shortened inseam, the result was less "droop and drag" to help reduce tripping. To enhance the dignity of the wearer, Pet Parade material is tightly knitted. The dyed pants and printed gowns provide all-over opaque coverage.

| Item No. | Size | Color | Pkg |
|--|---------|-----------|---------|
| Pet Parade IV Gowns - Plastic Snaps | | | |
| MDT011489S | Small | Purple | 2 dz/cs |
| MDT011489M | Medium | Teal | 2 dz/cs |
| MDT011489L | Large | Lt. Blue | 2 dz/cs |
| MDT011489XL | X-Large | Dark blue | 2 dz/cs |
| Pet Parade Pants | | | |
| MDT011485S | Small | Purple | 2 dz/cs |
| MDT011485M | Medium | Teal | 2 dz/cs |
| MDT011485L | Large | Lt. Blue | 2 dz/cs |
| MDT011485XL | X-Large | Dark Blue | 2 dz/cs |

Tired tiger

Kids love Tired Tiger pediatric wear that features fun and friendly tigers resting quietly in the leaves.

Woven of comfortable 100% polyester, these laundry-friendly items hold up to high laundry temperatures and are guaranteed to remain flame-retardant for the life of the garment. Both the regular gowns and IV gowns have a straight back closure and are color-coded by size for easy identification. Comfortable PJ pants feature a no-fuss elastic waist.



MDT011386M

MDT011385M

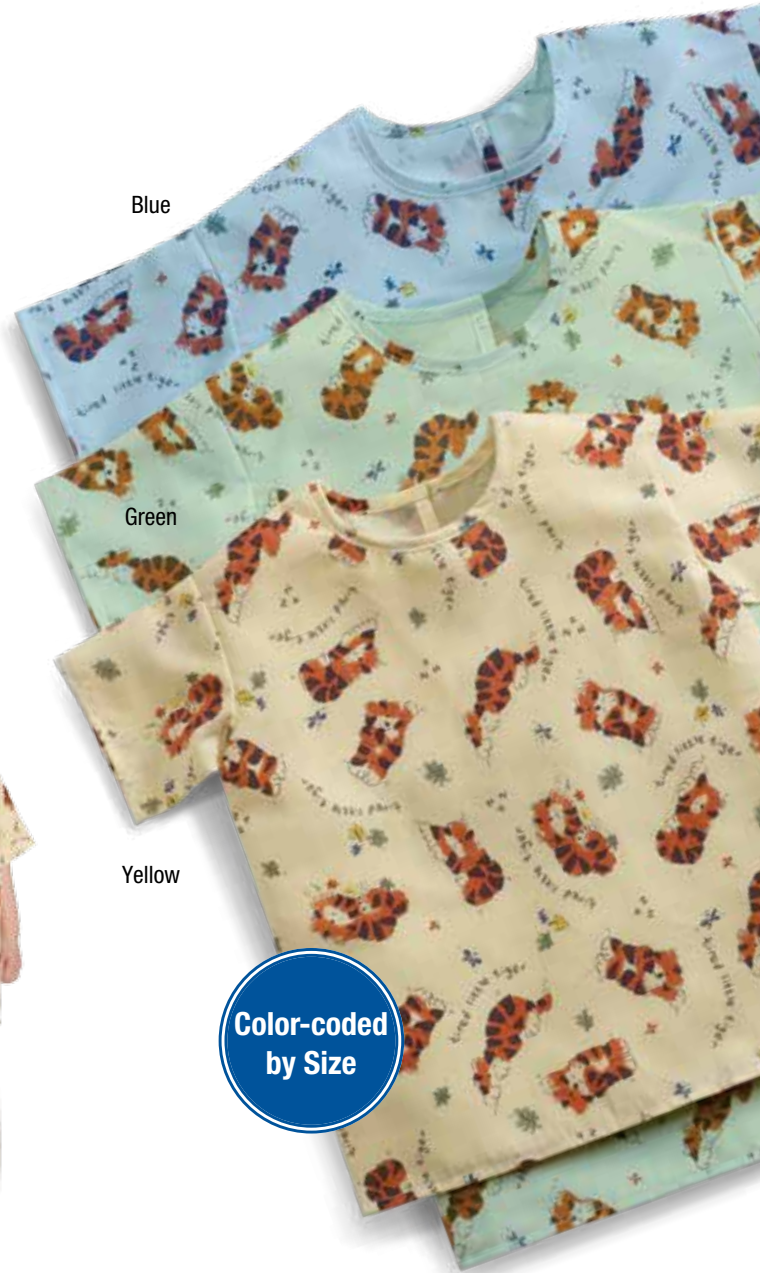

Blue

Green

Yellow

**Color-coded
by Size**

| Item No. | Size | Color | Pkg |
|-----------------------------------|--------|--------|---------|
| Pediatric Patient Gowns | | | |
| MDT011386S | Small | Yellow | 2 dz/cs |
| MDT011386M | Medium | Green | 2 dz/cs |
| MDT011386L | Large | Blue | 2 dz/cs |
| Pediatric Patient IV Gowns | | | |
| MDT011389S | Small | Yellow | 2 dz/cs |
| MDT011389M | Medium | Green | 2 dz/cs |
| MDT011389L | Large | Blue | 2 dz/cs |
| Pediatric PJ Pants | | | |
| MDT011385S | Small | Yellow | 2 dz/cs |
| MDT011385M | Medium | Green | 2 dz/cs |
| MDT011385L | Large | Blue | 2 dz/cs |

Size Guide

All Tired Tiger pieces use our Standard-Cut sizing. This chart shows the approximate age range for each unisex size.

- 2-4 years old.....Small
- 5-7 years old.....Medium
- 8-10 years old....Large

Snuggly solids



Soft. Economical. Laundry-friendly.
When you're thinking about a value-line of pediatric wear, you might think you could get one or two of these characteristics. With Snuggly Solids, you get all three.

MDT011377M

MDT011259M



Gowns and PJ Pants shown

| Item No. | Size | Color | Pkg |
|-----------------|--------|--------|---------|
| Shirt | | | |
| MDT011277S | Small | Yellow | 2 dz/cs |
| MDT011277M | Medium | Green | 2 dz/cs |
| MDT011277L | Large | Blue | 2 dz/cs |
| Gown | | | |
| MDT011377S | Small | Yellow | 2 dz/cs |
| MDT011377M | Medium | Green | 2 dz/cs |
| MDT011277L | Large | Blue | 2 dz/cs |
| PJ Pants | | | |
| MDT011259S | Small | Yellow | 2 dz/cs |
| MDT011259M | Medium | Green | 2 dz/cs |
| MDT011259L | Large | Blue | 2 dz/cs |

Standard-Cut Size Guide

All Snuggly Solids pieces use our Standard-Cut sizing. This chart shows the approximate age range for each unisex size.

- 2-4 years old.....Small
- 5-7 years old.....Medium
- 8-10 years old....Large

infant wear



Soft and sweet: that's what you'll find with every piece of Medline infant clothing. What's more, in each piece you can expect the quality, longevity and value that Medline is known for.



Take special care of baby

Infant Head Warmers and Booties

Our colorful and functional stockinette caps help keep infants warm. Made with a soft, warm knit. Choose from one-ply blue, pink or combo stripes. Also available as deluxe two-ply caps in solid white, blue, pink or pink/blue stripe.



One-Ply Infant Head Warmers

| Item No. | Color | Pkg |
|----------|-------|-----|
|----------|-------|-----|

One-Ply Infant Head Warmers

| | | |
|-------------|------------------|---------|
| MDT211434B | Blue Stripe | 50/pk |
| MDT211434M | Multi-Stripe | 50/pk |
| MDT211434P | Pink Stripe | 50/pk |
| MDT211434PB | Pink/Blue Stripe | 50/pk |
| MDTDDR031W | White | 1 dz/cs |

Two-Ply Infant Head Warmers

| | | |
|---------------|------------------|-----------|
| MDT211434HPB2 | Pink/Blue Stripe | 200 ea/cs |
| MDT211440W | Solid White | 5 dz/cs |
| MDT211440B | Solid Blue | 5 dz/cs |
| MDT211440P | Solid Pink | 5 dz/cs |

Cap & Booties

| | | |
|------------|---------------|---------|
| MDT211432* | Cap & Booties | 1 dz/cs |
| MDT211433* | Booties | 1 dz/cs |

*Insert P, B, or W for colors Pink, Blue or White



Two-Ply Infant Head Warmers



Makes Dressing Infants Easy

Slipover Infant Shirts

Easy and convenient

These fine, ultra-soft shirts come in a wide range of sizes to fit all babies. Expansive lap shoulders help shirt slip over baby's head with ease. Choose from three styles: short sleeve, long sleeve or protective mitten cuff.

| Item No. | Size | Color | Pkg |
|---------------------|-----------|--------------|---------|
| Short Sleeve | | | |
| MDT2112551 | 3 months | White/Orange | 6 dz/cs |
| MDT2112552 | 6 months | White/Green | 6 dz/cs |
| MDT2112554 | 12 months | White | 6 dz/cs |
| MDTDDR056BNB | 3 months | Blue | 1 dz/cs |
| MDTDDR057BNB | 3 months | Pink | 1 dz/cs |
| MDT2112906 | 18 months | White | 6 dz/cs |

Long Sleeve

| | | | |
|------------|----------|--------------|---------|
| MDT2112571 | 3 months | White/Orange | 6 dz/cs |
|------------|----------|--------------|---------|

Long Sleeve, Mitten Cuff

| | | | |
|------------|----------|--------------|---------|
| MDT2112601 | 3 months | White/Orange | 6 dz/cs |
| MDT2112602 | 6 months | White/Green | 6 dz/cs |



Tie-Side Infant Shirts

Easy to put on, easy to take off

These comfy white shirts of fine, ultra-soft yarns tie securely at the side so they're easy to work with. Available in two styles: short sleeve or protective mitten cuff.

| Item No. | Size/Color | Pkg |
|----------|------------|-----|
|----------|------------|-----|

Short Sleeve

| | | |
|------------|------------------------|---------|
| MDT2112731 | 3 months, White/Orange | 6 dz/cs |
|------------|------------------------|---------|

Long Sleeve, Mitten Cuff

| | | |
|------------|------------------------|---------|
| MDT2112751 | 3 months, White/Orange | 6 dz/cs |
| MDT2112752 | 6 months, White/Orange | 6 dz/cs |



Snap-Side Shirts

Make dressing a snap

These white shirts are made of fine, ultra-soft yarns that fasten securely at the side with snaps. Your choice of two styles—short sleeve or protective mitten cuff.

| Item No. | Size | Pkg |
|---|--------------|----------|
| Short Sleeve (white) | | |
| MDTDDR075NB | 0-12 months | 1 dz/cs |
| MDTDDR075S | 24 months | 12 dz/cs |
| Long Sleeve, Mitten Cuff (white) | | |
| MDTDDR071P | Preemie | 1 dz/cs |
| MDT2112701 | 3 months* | 6 dz/cs |
| MDT2112702 | 6 months* | 6 dz/cs |
| MDT2112706 | 12-18 months | 6 dz/cs |



Pediatric One-Piece

Super soft on baby's skin

Long and short-sleeve body shirts feature three snaps at the bottom for easy dressing and diaper changes. Ultra soft 100% cotton knit fabric is gentle on baby's delicate skin.

| Item No. | Size/Color | Pkg |
|---------------------|-----------------|---------|
| Long Sleeve | | |
| MDTDDR009 | 3 month, White | 1 dz/cs |
| Short Sleeve | | |
| MDTONESIES | 3 month, White | 1 dz/cs |
| MDTONESIES1 | 6 month, White | 1 dz/cs |
| MDTONESIES2 | 12 month, White | 1 dz/cs |
| MDTONESIES3 | 18 month, White | 1 dz/cs |



IV Gowns

Easy access and comfort, too

Soft gown is kind to the most sensitive skin. Sleeves open and close with plastic snaps, so you can change this gown without disrupting IVs or monitor leads.

| Item No. | Description | Pkg |
|-------------|-------------------|----------|
| MDT01144PRE | Lt. Green Preemie | 24 ea/cs |
| MDT01144INF | Lt. Green Infant | 24 ea/cs |



Sleep Sack

Keep loose blankets out of baby's face

The Sleep Sack is a wearable blanket that keeps baby cozy and warm without loose blankets, which the NICHD* recommends keeping out of cribs. Zipper front makes easy access for diaper changes, checkups and monitor lead care.

| Item No. | Description | Pkg |
|-------------|-------------|----------|
| MDT01144SAC | Lt. Blue | 24 ea/cs |

Kuddle-Up baby blankets

The Kuddle-Up blanket is one of Medline's biggest selling products of all time. Its story has even been featured on National Public Radio. The familiar blue and pink stripes have been used to swaddle newborns from every corner of the globe.

The simple blanket is a minor character in the momentous occasion that is childbirth. The same absorbent softness and durable washability now comes in multiple sizes and fun, gender-neutral prints—and of course our familiar blue and pink stripes.





The Classic

The Latest

| Item No. | Description | Size | Pkg |
|--------------|---|-----------|----------|
| MDTPB3C40STR | White w/Pink and Blue Border Stripes | 30" x 40" | 72 ea/cs |
| MDTPB4C40STR | White w/Pink and Blue Border Stripes | 36" x 40" | 72 ea/cs |
| MDTPB3B40STR | White w/Pink and Blue Border Stripes, 85% Cotton/15% Polyester | 30" x 40" | 72 ea/cs |
| MDTPB4C40ELE | Elephant Print | 30" x 40" | 72 ea/cs |



Medline Kuddle-Up Baby Blankets

Sooooo soft!

Babies will definitely cuddle into these all-cotton, flannelized blankets. So soft, warm and fluffy, they work wonderfully as attractive crib or receiving blankets.

| Item No. | Description | Size | Pkg |
|--------------|------------------------------|-----------|----------|
| MDTPB3C40CHK | Chick Print | 36" x 40" | 72 ea/cs |
| MDTPB3C40DNO | Dinosaur Print | 30" x 40" | 72 ea/cs |
| MDTPB3C36STR | Candystripe, Heavyweight | 36" x 36" | 72 ea/cs |
| MDTPB4C40DUK | Duck Print, Heavyweight | 36" x 40" | 72 ea/cs |
| MDTPB3C40FTP | Baby Foot Print, Heavyweight | 34" x 40" | 72 ea/cs |

Tuckable and Swaddling Blanket

This blanket is extra wide so the ends can tuck under the crib mattress to make a comforting cover or an extra measure of swaddling. Cheery chick-and-flowers print is cute as it can be.

| Item No. | Description | Pkg |
|--------------|-------------|----------|
| MDTPB3C46CHK | 20" x 46" | 72 ea/cs |

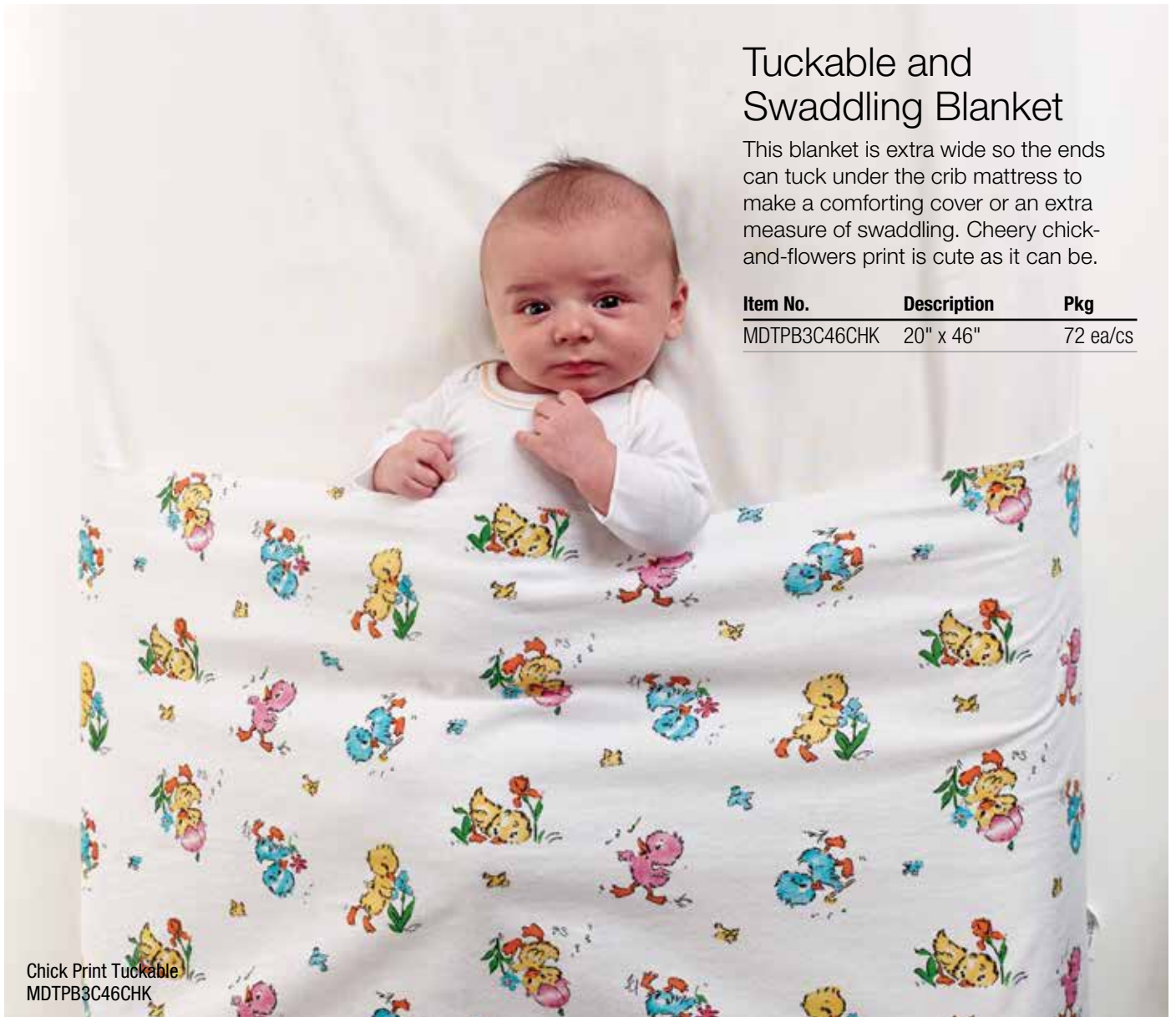

Chick Print Tuckable
MDTPB3C46CHK

Supreme Thermal Baby Blankets

Super soft and warm

These knitted, all-cotton, waffle-weave thermal blankets are the best way to keep babies warm and cozy. Heavyweight blankets have durable, bound edges for strength and long wear, with tightly knit yarns that will minimize snagging. Size is a full 30" x 40".

| Item No. | Description | Pkg |
|--------------|-------------|----------|
| MDTPB3C40PNK | Pink | 24 ea/cs |
| MDTPB3C40BLU | Blue | 24 ea/cs |
| MDTPB3C40FPY | Yellow | 24 ea/cs |
| MDTPB3C40MNT | Mint | 36 ea/cs |
| MDTPB5C40WHI | White | 72 ea/cs |



Mint

Yellow

Blue

Pink

Classic
Pastels

Brighten up Baby's Crib



Blue

Yellow

Pink

Green

White

Medline Colorful Knitted Sheets

Brighten the bed with these 100% cotton knitted crib sheets that provide excellent warmth and comfort for babies. Assorted pastels include white, yellow, pink, green and blue.

| Item No. | Description | Pkg |
|------------|----------------------------------|---------|
| MDT211479 | 28" x 52" x 6", Assorted Pastels | 2 dz/cs |
| MDT211479Y | 28" x 52" x 6", Yellow Pastel | 2 dz/cs |
| MDT211479G | 28" x 52" x 6", Green Pastel | 2 dz/cs |

Comfy and Colorful



Medline Woven Crib Sheets

These sheets are made of 100% cotton for exceptional comfort and absorbency. Contour styled sheets fit snugly to provide infants with a smooth, flat surface. Available in white or assorted prints in just the size you need.

| Item No. | Description | Pkg |
|-----------|-----------------------|---------|
| MDT211482 | 24" x 38" x 2", Print | 2 dz/cs |
| MDT211470 | 28" x 52" x 6", White | 2 dz/cs |
| MDT211472 | 28" x 52" x 6", Print | 2 dz/cs |



Soft-Fit® Knitted Bassinet and Crib Sheets

Baby's sensitive skin is caressed by the soft, breathable, abrasion-resistant surface of Soft-Fit fabric. For safe sleep, the NICHD recommends using a fitted sheet on a crib mattress.* Soft-Fit contours easily and stays smoother longer. Hem threads are color coded for easier sorting.

| Item No. | Description | Pkg |
|-----------|----------------------------|---------|
| MDT218525 | 13" x 27" x 2", White Hem | 5 dz/cs |
| MDT218515 | 28" x 52" x 4", Brown Hem | 5 dz/cs |
| MDT218510 | 30" x 60" x 4", Purple Hem | 5 dz/cs |



**Makes a
Great Burp
Cloth Too**

Birdseye Burp Cloths

The distinctive birdseye weave was found in the diapers that grandma and grandad wore. It still makes one of the softest, most effective burp cloths you'll find anywhere.

| Item No. | Description | Size | Pkg |
|------------|--------------------|-----------|----------|
| MDT211396Z | White, 100% Cotton | 27" X 27" | 10 dz/cs |
| MDT211396R | White, 100% Cotton | 27" X 27" | 50 dz/cs |

Pre-Folded Gauze Diapers

Pre-folding lets you easily store and access these diapers. Two-ply, 100% cotton diapers have a four-ply, super-absorbent center panel for excellent wetness control. They also make great burp cloths.

| Item No. | Description | Size | Pkg |
|------------|--------------------|-------------|----------|
| MDT211398Z | White, 100% Cotton | 12" x 16.5" | 10 dz/cs |
| MDT211398R | White, 100% Cotton | 12" x 16.5" | 50 dz/cs |
| MDT211399Z | White, 100% Cotton | 14.5" x 21" | 10 dz/cs |
| MDT211399R | White, 100% Cotton | 14.5" x 21" | 50 dz/cs |



Bed Pad

The high-tech material in our bed pad is both waterproof and breathable, the perfect combination for a comfortable sleeping surface and excellent bedding protection. Sized to fit standard size pediatric beds, it lays flat and launders well, too.

| Item No. | Description | Size | Pkg |
|--------------|-------------|-----------|---------|
| MDTIU7SKLBLU | Bassinet | 12" x 15" | 6 dz/cs |
| MDTIU7SBCBLU | Crib | 24" x 34" | 2 dz/cs |



pediatric supplies

Pediatric products from Medline go far beyond apparel and linens. These pages introduce you to some of the most popular pediatric specialties from our catalog of over 350,000 healthcare supplies. The best news is that one call to your Medline rep is all you need for more information or to order any item.

Digital Baby Scale

- Accurately and quickly weigh and measure even the most active babies with this scale
- Sleek, extremely durable, easy-to-clean and maintain
- Weight capacity: 44 lb x 0.5 oz (or toggle to kg)
- Large, easy-to-read 1" liquid crystal display
- Built-in measuring tape, 0-22.5"
- AC adaptor included, four AA batteries optional
- 2-year limited warranty



MDR107423

| Item No. | Description | Pkg |
|-----------|--------------------|------|
| MDR107423 | Digital Baby Scale | 1 ea |
| MDR112570 | Carry Case | 1 ea |



Fish Tales Print

Exam Table Paper

| Item No. | Description | Pkg |
|-------------------------------|--------------------------------|-------|
| Deluxe Rolls - White | | |
| NON24322 | Smooth, 18" x 225' | 12/cs |
| NON24323 | Smooth, 20" x 225' | 12/cs |
| NON24326 | Smooth, 21" x 225' | 12/cs |
| NON24329 | Crepe, 14.5" x 125' | 12/cs |
| NON24324 | Crepe, 18" x 125' | 12/cs |
| NON24325 | Crepe, 21" x 125' | 12/cs |
| Standard Rolls - White | | |
| NON23319 | Smooth, 14.5" x 225' | 12/cs |
| NON23322FT | Smooth, 18" x 225' | 12/cs |
| NON23323 | Smooth, 20" x 225' | 12/cs |
| NON23326 | Smooth, 21" x 225' | 12/cs |
| NON23324FT | Crepe, 18" x 125' | 12/cs |
| NON23321 | Crepe, 20" x 125' | 12/cs |
| NON23325 | Crepe, 21" x 125' | 12/cs |
| Printed Rolls | | |
| NON23324FT | Crepe, Fish Tales, 18" x 125' | 6/cs |
| NON23322FT | Smooth, Fish Tales, 18" x 225' | 6/cs |

Infant Scale Paper



| Item No. | Description | Pkg |
|-------------|-------------------------|---------|
| NON253200CS | Infant Crepe, 18" x 24" | 1000/CS |
| NON243200 | Infant Crepe, 20" x 30" | 1000/CS |

Professional Disposable Towels

| Item No. | Description | Pkg |
|---|-------------------------------|--------|
| Pro Towels, 2-Ply Tissue/Poly | | |
| NON24356W | Tissue/Poly, 13" x 18", White | 500/cs |
| NON24356B | Tissue/Poly, 13" x 18", Blue | 500/cs |
| NON24361 | Tissue/Poly, 17" x 19", White | 500/cs |
| Pro Towels, 3-Ply Tissue and Tissue/Poly | | |
| NON24357W | Tissue, 13" x 18", White | 500/cs |
| NON24357B | Tissue, 13" x 18", Blue | 500/cs |
| NON24359 | Tissue, 17" x 19", White | 500/cs |
| NON24358W | Tissue/Poly, 13" x 18", White | 500/cs |
| NON24358B | Tissue/Poly, 13" x 18", Blue | 500/cs |

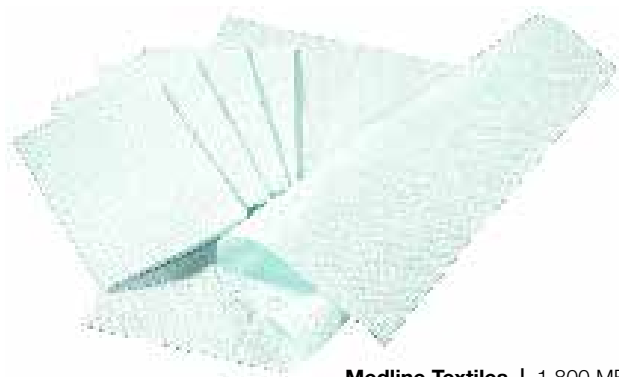



30-Second Digital Oral/Rectal Thermometers

- Accurate readings in about 30 seconds
- Large LCD screen for easy readings
- Simple push-button start
- Disposable sheaths allow for sanitary oral, rectal or axillary use

| Item Number | Description | Pkg |
|-------------|--------------------------------|--------|
| MDS9850H | Premier, Oral °F & °C | 1 ea |
| MDS9852H | Premier, Rectal °F | 1 ea |
| MDS98801Z | Flex-tip, waterproof, °C or °F | 1 ea |
| MDS9607 | Oral Sheaths | 100/bx |
| MDS9608 | Rectal Sheaths | 100/bx |



Digital Thermometer Sheaths

- Fits most pocket-style digital thermometers
- Helps reduce cross-contamination

| Item No. | Description | Pkg |
|----------|---------------|--------|
| MDS9607 | Oral Sheath | 100/bx |
| MDS9608 | Rectal Sheath | 100/bx |

Medline Tympanic Thermometer

- Takes an accurate, non-invasive reading from the tympanic membrane with a single touch
- Touch-free probe cover release saves time and reduces cross-contamination
- Readings in Fahrenheit and Celsius
- For use on patients of any age
- Includes 100 disposable probe covers



| Item No. | Description | Pkg |
|----------|----------------------|--------|
| MDS9700 | Tympanic Thermometer | 1 ea |
| MDS9701 | Cover for MDS9700 | 100/bx |

Instant Read Digital Temple Thermometer

- Sensors track the heat flow generated from blood vessels to the skin's surface and accurately convert measurements to body temperature
- Non-invasive, easy-to-use asleep or awake
- Large digital display, audible "ready" beep



| No. | Description | Pkg |
|---------|--------------------|--------|
| MDS9698 | Temple Thermometer | 1/ea |
| MDS9699 | Probe Covers | 250/bx |

Medline Pro Neoprene Handheld Aneroids



- Durable neoprene tubing and bladder, no latex used in manufacturing
- Exceptional accuracy from a top-quality, zinc alloy precision gauge
- Nylon rangefinder cuff for quick, convenient patient fitting
- No-stop pin action for visual calibration check and added accuracy
- Carrying case included

| Item No. | Ordering Description | Pkg |
|-----------|---|------|
| MDS9386LF | Medline Pro Handheld Aneroid, Neoprene Tubing, Infant | 1 ea |
| MDS9387LF | Medline Pro Handheld Aneroid, Neoprene Tubing, Child | 1 ea |

Medline Plus PVC Handheld Aneroids



- PVC tubing and bladder, no latex used in manufacturing
- Nylon rangefinder cuff for quick, convenient patient fitting
- No-stop pin action for visual calibration check and added accuracy
- Carrying case included

| Item No. | Ordering Description | Pkg |
|----------|---------------------------------------|------|
| MDS9386 | Medline Plus Handheld Aneroid, Infant | 1 ea |
| MDS9387 | Medline Plus Handheld Aneroid, Child | 1 ea |



Medline Stainless Steel Stethoscopes

Each stethoscope is handcrafted from high tensile strength German stainless steel. Features durable 22" (56 cm) tubing.

- Color coordinated non-chill rings provide excellent patient comfort
- Includes one extra set of ear tips

| Item Number | Description | Pkg |
|------------------|-------------|------|
| Pediatric | | |
| MDS92200 | Gray | 1 ea |
| Neonatal | | |
| MDS92150 | Gray | 1 ea |
| MDS92160 | Pink | 1 ea |

Ear/Ulcer Syringe

The ear/ulcer syringe is ideal for irrigating smaller wounds and cleansing nasal passages of newborns.



| Item No. | Description | Qty |
|-----------|----------------------------------|----------|
| DYND70280 | Sterile ear/ulcer syringe, 2 oz. | 50 ea/cs |
| DYND70277 | Sterile ear/ulcer syringe, 3 oz. | 50 ea/cs |

Medline Plus General Monitoring Cloth Electrode

- Patient comfort and minimal moisture buildup from the non-woven, breathable, porous cloth material that stretches and conforms to the body
- Useful for long-term monitoring with high-tack medical-grade adhesive

| Item No. | Description | Packaging |
|------------|------------------------------------|------------------------|
| MDS611303A | General Monitoring Cloth Electrode | 3/pk, 60/bx, 600/cs |
| MDS611305A | General Monitoring Cloth Electrode | 5/pk, 100/bx, 1,000/cs |



General Monitoring Electrode
MDS611303A

Medline Plus Radiotranslucent Neonatal Electrode

- Gentle for neonatal patients with a conductive adhesive hydrogel and breathable stretchable material
- Prewired for added convenience

| Item No. | Description | Packaging |
|-----------|---|--------------|
| MDS61115R | Radiotranslucent Neonatal Electrode, 1.5 mm | 3/pk, 300/cs |

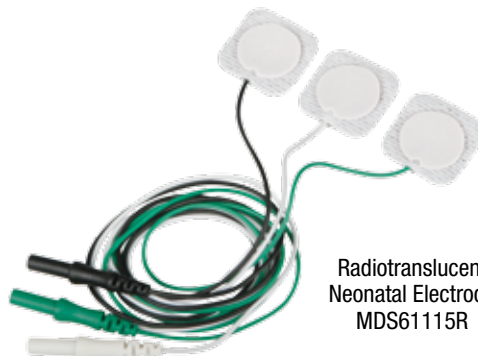

Radiotranslucent Neonatal Electrode
MDS61115R

Disposable Neonatal Cuffs

- Available in sizes from 3 cm to 15 cm
- Option of one tube or two
- Soft fabric for tender skin, hook-and-loop closures

| Cuff Size (Limb Circumference) | 1-Tube Connector | 2-Tube Connector | Pkg. |
|-----------------------------------|---------------------|---------------------|-------|
| Neonatal # 1 (3 – 6 cm) | MDS9741 | MDS9751 | 10/bx |
| Neonatal # 2 (4 – 8 cm) | MDS9742 | MDS9752 | 10/bx |
| Neonatal # 3 (6 – 11 cm) | MDS9743 | MDS9753 | 10/bx |
| Neonatal # 4 (7 – 14 cm) | MDS9744 | MDS9754 | 10/bx |
| Neonatal # 5 (8 – 15 cm) | MDS9745 | MDS9755 | 10/bx |



latexfree
PRODUCT

Note: Cuffs made of vinyl are available on items listed.
Place a "V" after the connector type code to order.



latexfree
PRODUCT

Medline Blood Pressure Cuffs

Cuff Size
(Limb Circumference)

Infant (8 – 14 cm)
Child (13 – 20 cm)
Small Adult (18 – 26 cm)



Dinamap
Connector
2-Tube

Bayonet-Style
Connector
1-Tube

Marquette Female
Connector
2-Tube

| | | |
|-----------|-----------|-----------|
| MDS9710DM | MDS9720HP | MDS9710MQ |
| MDS9711DM | MDS9721HP | MDS9711MQ |
| MDS9712DM | MDS9722HP | MDS9712MQ |

DoggyNeb® Pediatric Nebulizer

- Child-friendly alternative to standard nebulizers / compressors
- Effective dry piston compressor, 10 ml nebulizer capacity
- Includes pediatric and adult-size masks plus a pacifier mouthpiece
- Grab-N-Go backpack stores DoggyNeb and supplies



| Item No. | Description | Pkg. |
|-----------|-----------------------------------|-------|
| HCSDOGNEB | Pediatric Nebulizer Compressor | 8/cs |
| HCS60004F | Replacement Filters for HCSDOGNEB | 10/pk |



Pediatric
BCE300C53

Digital Finger Pulse Oximeter

- Friendly frog design comforts young patients
- Provides fast, reliable SpO2, pulse rate and pulse strength measurements
- Pocket-size with a large LED display
- Auto power shutdown after 8 seconds

ID Bracelets

- Soft vinyl is strong, yet comfortable
- Protected label inside the wristband pocket for maximum convenience and security
- Tamper-resistant snap closure

| Item No. | Color | Lines | Dimensions | Pkg |
|------------------------|-----------|-------|-------------------|-----------|
| Pediatric | | | | |
| MDS133039W | White | 4 | 6 5/8" L x 3/4" W | 250 ea/bx |
| MDS133039B | Lt. Blue | 4 | 6 5/8" L x 3/4" W | 250 ea/bx |
| MDS133039P | Pink | 4 | 6 5/8" L x 3/4" W | 250 ea/bx |
| MDS133039C | Clear | 4 | 6 5/8" L x 3/4" W | 250 ea/bx |
| Adult/Pediatric | | | | |
| MDS133038C | Clear | 5 | 10" L x 1" W | 250 ea/bx |
| MDS133038P | Pink | 5 | 10" L x 1" W | 250 ea/bx |
| MDS133038G | Lt. Green | 5 | 10" L x 1" W | 250 ea/bx |
| MDS133038R | Red | 5 | 10" L x 1" W | 250 ea/bx |
| MDS133038Y | Yellow | 5 | 10" L x 1" W | 250 ea/bx |
| MDS133038W | White | 5 | 10" L x 1" W | 250 ea/bx |
| MDS133038B | Blue | 5 | 10" L x 1" W | 250 ea/bx |
| MDS133038O | Orange | 5 | 10" L x 1" W | 250 ea/bx |



Pediatric
MDS133039B

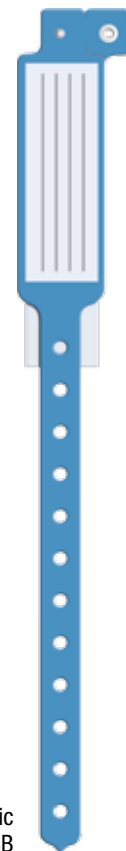

Adult/ Pediatric
MDS133038B

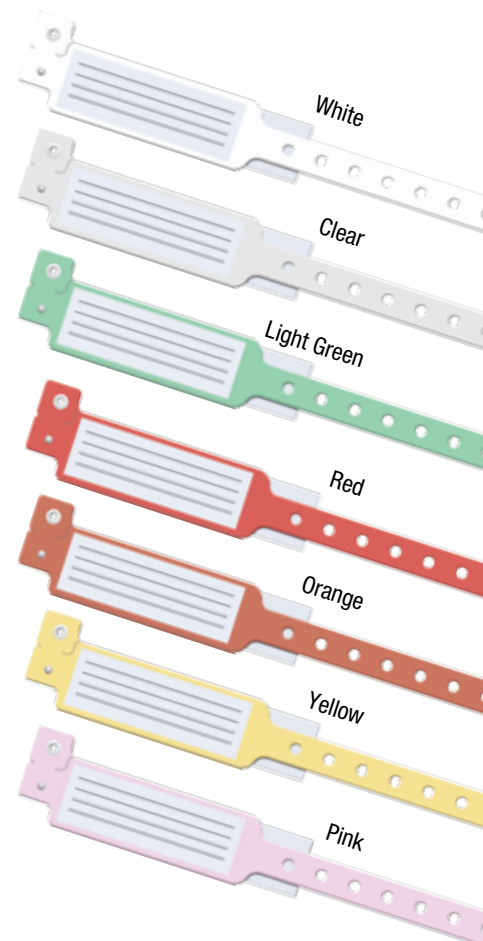

Dry Time® Baby Diapers

- Fully breathable for increased airflow and comfort
- Cloth-like outer cover is comfortable against skin, reducing the risk of irritation and rashes
- Anti-leak guards for maximum containment
- No-tear tape surface for easy fastening and refastening
- Soft foam-elastic waistband provides a better fit and leakage protection

| Item No. | Size | Weight | Case / Bag |
|-----------|------|-------------------------|---------------|
| MSC266041 | 1 | Preemie | 240/cs, 20/bg |
| MSC266042 | 2 | 6-14 lbs (3 kg-6 kg) | 224/cs, 28/bg |
| MSC266043 | 3 | 12-24 lbs (6 kg-11 kg) | 192/cs, 24/bg |
| MSC266044 | 4 | 22-35 lbs (10 kg-16 kg) | 160/cs, 20/bg |
| MSC266045 | 5 | 30-38 lbs (14 kg-17 kg) | 144/cs, 18/bg |
| MSC266046 | 6 | 35+ lbs (16+ kg) | 120/cs, 15/bg |



Dry Time® Training Pants

- Full-stretch continuous waistband means they're just like real underwear – easy on, easy off
- Odor-inhibiting polymer improves dryness, containment and skin care
- Cloth-like outer cover is comfortable against skin, reducing the risk of irritation and rashes
- Easy change design lets you just tear along the side seam for quick removal

| Item No. | Size | Weight | Case / Bag |
|----------|------------------------|-------------------------|---------------|
| HSP29817 | Medium, unisex, 2T-3T | 20-32 lbs (9 kg-15 kg) | 136/cs, 17/bg |
| HSP29815 | Large, unisex, 3T-4T | 32-40 lbs (15 kg-19 kg) | 120/cs, 15/bg |
| MSC29813 | X-Large, unisex, 4T-5T | 38+ lbs (18+ kg) | 104/cs, 13/bg |



Cleansing Wipes

- Soft, non-woven cloths are smoother than a washcloth
- Gentle cleaning solutions are kind to delicate skin
- ReadyFlush® (only) can be flushed like toilet paper

| Item No. | Description | Pkg |
|------------|--|------------------------|
| MSC263153 | Aloe Touch® Sensitive 5.5" x 7.25" | 80 wipes/pk, 24 pks/cs |
| MSC263150A | Aloe Touch® SELECT Premium, 7" x 8" | 80 wipes/pk, 15 pks/cs |
| MSC263820 | ReadyFlush JR.® Biodegradable Flushable, 7" x 8" | 40 wipes/pk, 24 pks/cs |



Packaged in bowl and shrink-wrapped



Basic Baby Kit DYKD200COLB

- 1 ea – Baby Wash, Head-to-Toe, 1 oz. (30 ml)
- 1 ea – Bowl, Non-sterile, 32 oz. (946 ml)
- 1 ea – Baby Lotion, 1 oz. (30 ml)
- 1 ea – Baby Scrub Brush, Baby
- 1 ea – Syringe, Ear and Ulcer, Sterile, 2 oz. (59 ml)

Packaged in a drawstring bag, printed with a baby design



Premium Baby Kit DYKD1002B

- 12 ea – Alcohol Prep Pads, 2-ply, Large
- 1 ea – Baby Wash, Head-to-Toe, 1 oz. (30 ml)
- 1 ea – Comb and Brush Set
- 20 ea – Diaper, Newborn, Up to 10 lbs. (4.5 kg)
- 1 ea – Hat, Baby Boggan Style
- 1 ea – Pacifier, Silicone
- 1 ea – Scrub Brush, Baby
- 1 ea – Syringe, Ear and Ulcer, Sterile, 2 oz. (59 ml)
- 1 pk – Wipes, Lanolin, 6.7" x 8.25" (17 cm x 21 cm), 35 wipes/pack

Packaged in a plastic lunchbox style tote.



Lunchbox Kit DYKD2446LBP

- 1 ea – 1 oz. (30 mL) Head-to-Toe Baby Wash
- 1 ea – 16 oz. (473 mL) Carafe with Farm Animal Design
- 1 ea – Lunch Box with Farm Animal Design
- 1 ea – Coloring Book and 4/pk crayons
- 1 ea – 5" (13 cm) Comb
- 1 ea – 1 oz. (30 mL) Baby Lotion
- 1 ea – Pocket Size Tissue Pack (15 sheets/pk)
- 1 ea – Individually Wrapped Pediatric Toothbrush
- 1 ea – 6 oz (17 g) Fluoride Toothpaste

Packaged in a drawstring bag, printed with a pediatric design



Pediatric Admissions Kit DYKD1002P

- 1 ea – Baby Bath, 2 oz. (59 ml)
- 1 ea – Carafe, 16 oz. (473 ml)
- 1 ea – Coloring Book
- 1 ea – Comb, 5" (13 cm)
- 1 pk – Crayons, 4/pk
- 1 ea – Emesis Basin, 500 ml (17 oz)
- 1 ea – Lotion, Baby Scented, 2 oz. (59 ml)
- 1 ea – Shampoo, Tearless, 2 oz. (59 ml)
- 1 pr – Single Tread Slippers, Toddler
- 1 bx – Standard Facial Tissues, 5.7" x 7" (14 cm x 18 cm), 40 sheets/box
- 1 ea – Toothbrush, Pediatric, Individually Wrapped
- 1 ea – Toothpaste, Fluoride, .6 oz (17 g)
- 1 ea – Wash Basin, Rectangular, 6 qt. (6 L)

Packaged in a printed backpack



Premium Pediatric Admission Kit DYKD2008PD

- 1 ea – 2 oz. (59 mL) Baby Bath
- 1 ea – 16 oz. (473 mL) Carafe
- 1 ea – Coloring Book and 4/pk Crayons
- 1 ea – 5" (13 cm) Comb
- 1 ea – 17 oz. (500 mL) Emesis Basin
- 1 ea – 2 oz. (59 mL) Scented Baby Lotion
- 1 ea – 2 oz. (59 mL) Tearless Shampoo
- 1 ea – Single Tread Toddler Slippers
- 1 ea – Standard Facial Tissues (5.7" x 7", 14 cm x 18 cm), 40 sheets/box
- 1 ea – Individually Wrapped Pediatric Toothbrush
- 1 ea – .6 oz Fluoride Toothpaste
- 1 ea – 6 qt. (6 L) Rectangular Wash Basin



Arm Sling—Pediatric Print with Shoulder Pad

- Sized for infants, toddlers and children
- Friendly dinosaurs help immobilize the arm
- Washable

| Item No. | Size | Dimensions | Pkg |
|-------------|---------|-----------------------------|-----|
| ORT11400XSD | Infant | 9.5" x 5.5" (24 x 14cm) | 2 |
| ORT11400XSD | Toddler | 10.75" x 6.5" (27.3 x 16cm) | 2 |
| ORT11400SD | Child | 12" x 5.75" (30.5 x 14.6cm) | 4 |



Strider Prescription Walker

- Infinite configurations accommodate the special needs of children with disabilities
- Handles adjust without tools
- Extra wide base for stability and balance

| Item No. | Description | Wheels Inch (cm) | Weight Capacity Lbs (kg) | Approximate User Height Inch (cm) | Width Inside Hand Grip Inch (cm) | Height Adjustment Inch (cm) | Folded Width Inch (cm) | Pkg |
|----------|--------------|---------------------|-----------------------------|--------------------------------------|-------------------------------------|--------------------------------|---------------------------|------|
| G07782 | Folding, Red | 5 (13) | 90 (41) | 2'2"-3'6" (66-107) | Adjustable | 14-19.5 (36-50) | 9.5 (24) | Each |

Underarm Crutches

- Durable aluminum construction
- Replaceable pads and tips
- **Deluxe Crutch** features the I-Beam design with dual rivets to help reduce wobbliness
- **Premium Red-Dot Crutch** features the easy clip lock handle for quick and easy sizing

Clip-lock, adjustable handle for quick and easy adjustments.

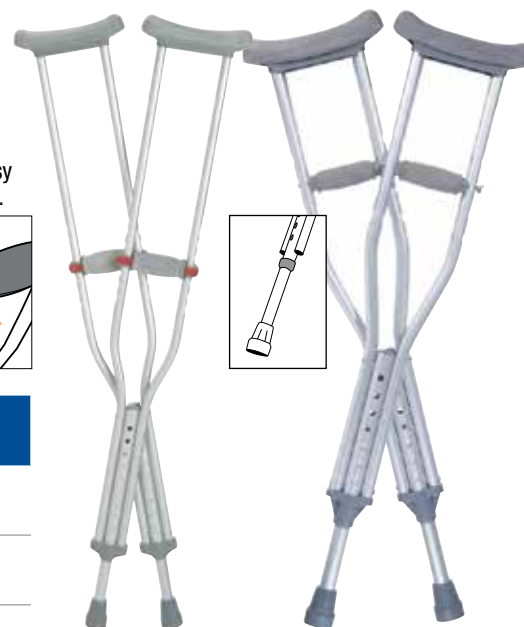
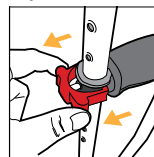

Premium Red-Dot

Deluxe Crutch

| Item | Description | Wt. Cap. Lbs (kg) | Patient Height Inch (cm) | Adj. Range Inch (cm) | Pkg |
|-----------|------------------------|----------------------|-----------------------------|-------------------------|---------|
| G92-214-8 | Premium Red-Dot; Youth | 300 (136) | 4'6"-5'2" (137-157) | 37-45 (94-114) | 8 pr/cs |
| MDSV80536 | Deluxe; Youth | 300 (136) | 4'6"-5'2" (137-157) | 36.5-44.5 (93-113) | 8 pr/cs |
| MDS80337Z | Child | 300 (136) | 4'0"-4'6" (122-137) | 31-37 (79-94) | 2 pr/cs |

Excel® Kidz Pediatric Wheelchair

- Adjustable telescoping handles for caregiver comfort
- Durable vinyl upholstery
- Treaded, flat-free tires for stable riding
- Anti-tippers included
- Standard dual axle for easy adjustment of seat height to hemi level
- Armrests and calf pads are upholstered and padded
- Desk-length, swing back arms
- Detachable elevating legrests
- Seat size 14" x 12" (36 cm x 30 cm)

MDS806140PEDE



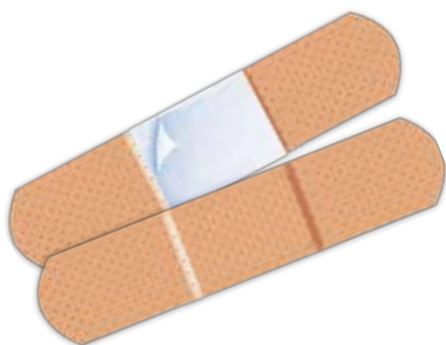

CUR47069



CUR45230N

CUR45227N



CUR45701



CUR45702



CURAD® Plastic Adhesive Bandages

Plastic is the bandage standard. Cost effective and comfortable everyday protection.

| Item No. | Description | Pkg |
|----------|--------------------------------|------------------------------|
| NON25509 | 3/8" x 1.5" (.95 cm x 3.81 cm) | 100/bx, 36 bx/cs, 3600 ea/cs |

CURAD Sesame Street® Adhesive Bandages

CURAD kid's adhesive bandages help make kids smile. These latex-free adhesive bandages are designed to fit kid-sized wounds and the fun colors and characters help turn frowns upside down.

| Item No. | Description | Pkg |
|----------|------------------------------|--------------------|
| CUR47069 | Assorted sizes | 24/bx, 24/ea, 4/cs |
| NON47070 | 3/4" x 3" (1.9 cm x 7.62 cm) | 100/bx, 12 bx/cs |



CURAD Sensitive Skin Bandages

Ideal for sensitive skin, these bandages have been specially designed to be gentle on skin. Absorbent non-stick pad is ouchless to remove.

| Item No. | Description | Pkg |
|-----------|------------------------------|--------|
| CUR45230N | Round, 1" (25mm) | 50/bx |
| CUR45227N | Strip, 3/4" x 3" (19 x 76mm) | 30/bx |
| CUR23056 | Strip, 3/4" x 3" (19 x 76mm) | 100/bx |



CURAD Camo Fabric Adhesive Bandages

CURAD kid's adhesive bandages help make kids smile. Designed to fit kid-sized wounds and help turn frowns upside down.

| Item No. | Description | Pkg |
|----------|---|-----------------|
| CUR45701 | Green Camo, 3/4" x 3" (19 x 76mm) | 24/bx, 25 bx/cs |
| CUR45702 | Pink & Blue Camo, 3/4" x 3" (19 x 76mm) | 24/bx, 25 bx/cs |

Yesterday's Classics, Tomorrow's Favorites

We're proud of both our classic products that have wrapped and warmed babies for generations and our new products that bring together up-to-the-minute designs and the latest in recommended care.



The Classics (Top to bottom)

- **Soft-Fit sheets** are recommended over flat sheets for safety* and convenience. *Page 22.*
- By popular demand, the classic **Noah's ark gown** is available once more. Knitted fabric, elastic hem, lap neck, mitten cuffs. Fits to 6 months. *Order item MDT011445 (1 dozen).*
- Roses are red, violets are blue, the stripes on this **cap** are both pink and blue. Warmth never looked so cute. *Page 15.*
- The **Kuddle-Up blanket** and its iconic pink and blue stripes has been continuously produced by Medline for nearly 50 years. No wonder it looks so familiar! *Page 19.*

The Latest (Top to bottom)

- **Mattress pad** protects bedding and lays flat for a smooth sleeping surface. *Page 23.*
- **IV gowns** for infants and preemies have snap arms for easy off-and-on without interference from leads or IVs. *Page 17.*
- **Multicolored caps** in various striped patterns. *Page 15.*
- **Kuddle-Up baby blankets** now feature the cutest new prints with the legendary softness of the original. *Page 19-20.*



MEDLINE TEXTILES
For Healthcare Professionals

Medline Cares

While you care for your smallest patients, Medline cares about the pediatric textiles that cover them, wrap them and keep them warm. But we understand that a soft blanket, a smooth knit sheet or a snuggly sleep sack does even more. Our pediatric products can help promote safe sleep,* patient satisfaction, comfort and even a sense of well-being. Let's care more...together.



MEDLINE TEXTILES

**National Institute of Child Health and Human Development (NICHD). What does a safe sleep environment look like? Available at: http://www.nichd.nih.gov/publications/pubs/documents/bts_safe_environment.pdf. Accessed July 9, 2013.*



Medline Industries, Inc.

One Medline Place
Mundelein, IL 60060

Medline United States
1-800-MEDLINE (633-5463)

www.medline.com | info@medline.com

Medline Canada
1-800-396-6996

www.medline.ca | canada@medline.com

Medline México
01-800-831-0898

www.medlinemexico.com | mexico@medline.com

Some products may not be available for sale in Mexico or Canada. We reserve the right to correct any errors that may occur within this brochure. ©2013 Medline Industries, Inc. All rights reserved. Aloe Touch, CURAD, DoggyNeb, Dry Time, Excel, Latex Free and Design, Medline, ReadyFlush, ReadyFlush Jr and Soft-Fit are registered trademarks of Medline Industries, Inc. Disney elements: ©Disney. Sesame Street is a registered trademark of Sesame Workshop Corporation.