

APPLICATION OF THE VISTA® COLLAR

1. PRE-FORM BACK ENDS

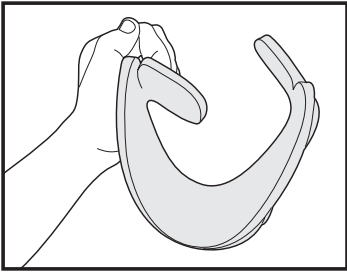

Pre-form the back ends of the side panels by squeezing them forcefully so they stay curved when released as shown on the right side above.

2. POSITION BACK PANEL

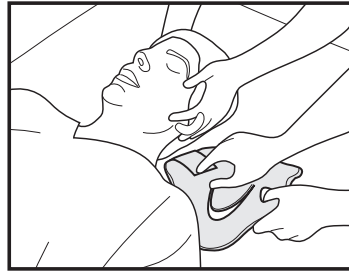

With the head held in neutral alignment, press the back panel down (to compress any bedding,) and slide it behind the patient's neck. Center the back panel so the loop straps are between the ear and trapezius.

3. PIVOT DOWN FRONT PANEL

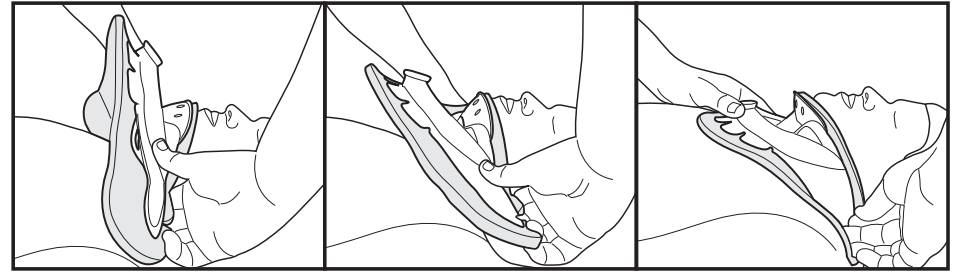

While pulling the sides of the collar apart, position the chin piece so it touches the patient's chin. Now pivot the collar down and in. Keep the chin piece in contact with the chin as the sides are positioned over the trapezius muscles.

4. DIAL UP THE HEIGHT

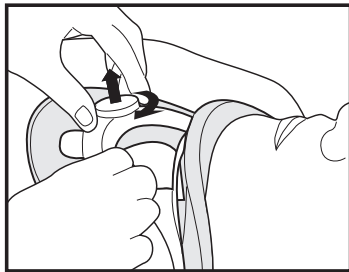

"Dial up" the height of the collar by pulling outward on the dial and turning clockwise. Stop when it becomes difficult to turn the dial further, and the foam pad on the chin piece is seen to compress.

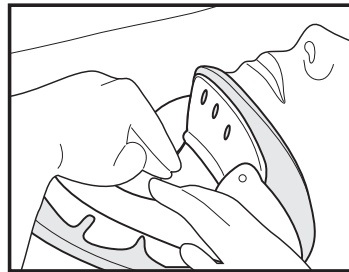

Check to see that the back of the chin piece is not pressing inward on the throat. If it is, lift the back ends of the side panels up, off of the trapezius muscles, which moves the chin piece forward, away from the throat.

5. ATTACH AND TIGHTEN

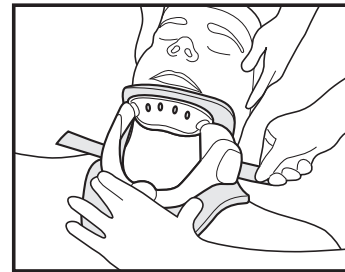

While holding the front panel in place, attach the loop strap on each side. To tighten the collar, anchor your thumb or fingers in the trach hole and peel back the loop strap on one side. Push inward on the back edge of the side panel while pulling the loop strap out. Now lift the strap up and reattach. Keep the back panel centered by tightening the other side equally. Repeat until all "slack" has been removed and a secure fit has been achieved.

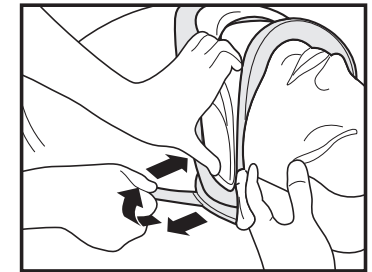

CHECK THE FIT

- ① **Chin Secure?** The patient should be in neutral and their chin should be well supported by the chin piece.
- ② **Slack-out?** All slack between the front and back panels must be removed to ensure a secure fit. If necessary, re-tighten on both sides.
- ③ **Airway OK?** Check that back edge of the chin piece does not press in on the patient's throat. If there is a concern, release the loop straps and lift the ends of the side panels off of the trapezius muscles to create the needed clearance at the throat. Reattach the loop straps and again tighten the collar.

TIPS

During the course of treatment, patient often changes position from supine to upright, or conversely from upright to supine. Positional changes often necessitate an adjustment in the height of the collar. Use the dial to change the height of the collar to the appropriate level depending upon the position of the patient. When checking over all application, remember to adjust the tightness of the collar if necessary.

READ INSTRUCTIONS BEFORE USE. Proper training in the use of this device should take place before it is applied. These directions are guidelines only and are not offered as medical recommendations.

THIS PRODUCT IS INTENDED FOR APPLICATION BY LICENSED HEALTH CARE PRACTITIONERS AS DIRECTED BY A PHYSICIAN OR OTHER QUALIFIED MEDICAL AUTHORITY. PERMANENT INJURY MAY RESULT FROM USE OTHER THAN AS DIRECTED BY A PHYSICIAN OR OTHER MEDICAL AUTHORITY. ASPEN MEDICAL PRODUCTS SPECIFICALLY DISCLAIMS ANY OBLIGATION OR LIABILITY FOR INJURY OR DAMAGE BY REASON OF ANY APPLICATION OF THIS PRODUCT. PLEASE SEE THE ACCOMPANYING LIMITED WARRANTY FOR FURTHER INFORMATION IN THIS REGARD.

LIMITED WARRANTY

Aspen Medical Products, Irvine, CA 92618, warrants to the user who originally purchases this product that it is free from defects in material and workmanship. The sole obligation of Aspen Medical Products in the event of breach of warranty shall be to repair or replace the defective product or part(s).

Aspen Medical Products shall have no obligation under this limited warranty in the event:

- (a) The product was not purchased from Aspen Medical Products or through its authorized channels of distribution;
- (b) The product is altered;
- (c) Any parts not supplied by Aspen Medical Products are inserted into the product; or
- (d) The product is not used in accordance with the Aspen Medical Products, Instructions for Use.

THE FOREGOING IS THE SOLE AND EXCLUSIVE REMEDY FOR FAILURE IN SERVICE OF, OR DEFECT IN, THE PRODUCT. ASPEN MEDICAL PRODUCTS SHALL NOT BE LIABLE UNDER THIS OR ANY IMPLIED WARRANTY FOR ANY DIRECT SPECIAL, INCIDENTAL, OR CONSEQUENTIAL DAMAGES. THIS WARRANTY IS IN LIEU OF ALL OTHER WARRANTIES, EXPRESS OR IMPLIED, INCLUDING THE WARRANTY OF MERCHANTABILITY OR FITNESS FOR A PARTICULAR PURPOSE OR USE, AND ALL OBLIGATIONS OR LIABILITIES ON THE PART OF ASPEN MEDICAL PRODUCTS FOR DAMAGES ARISING OUT OF OR IN CONNECTION WITH THE USE OF THE PRODUCTS, WHICH ARE HEREBY DISCLAIMED AND EXCLUDED BY ASPEN MEDICAL PRODUCTS.

This warranty gives you specific legal rights and you may have other rights which vary from state to state.

Warning: To ensure proper use, please review all material.

A listing of authorized distributors in your area is available upon request.